

NOTES:

1. JUNCTION IMPROVEMENTS WILL REQUIRE LAND ACQUISITION.
2. STOP LINE HAS BEEN PLACED 20m FROM JUNCTION TO ALLOW STACKING FOR 3No. LEFT TURNING VEHICLES ONTO NORTHERN ARM.
3. THE VISIBILITY FOR THE SIGNALS AT THE EXIT STOP LINE ARE SUBSTANDARD AND NEED TO BE REVIEW.
4. SIGNAL DESIGN TO BE UNDERTAKEN BY OTHERS.

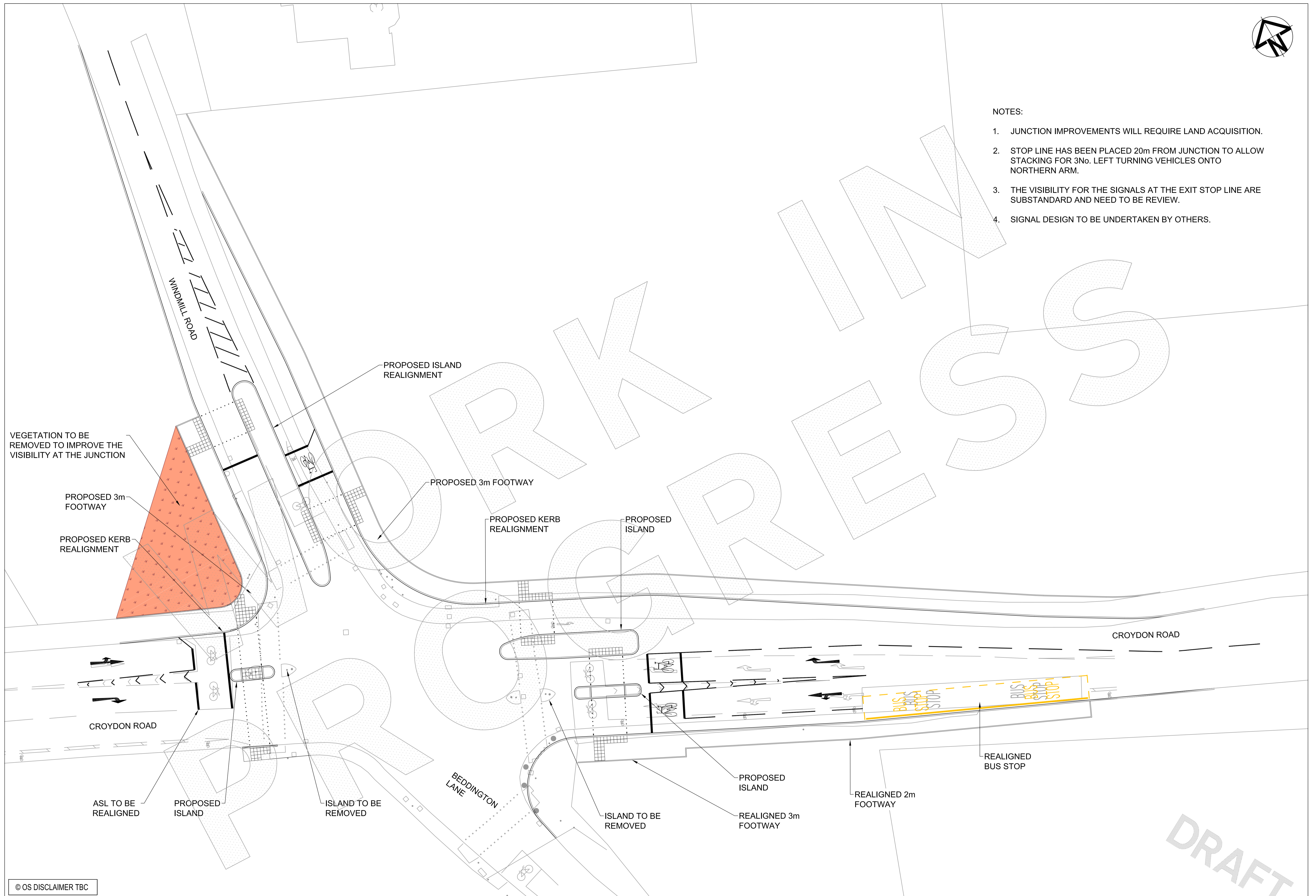

© OS DISCLAIMER TBC